



VERSCHRAUBUNGEN

Anschlussstücke, Tüllen, Verschlusschrauben,
Muttern, Schnellsteckverbindungen, Doppel- und Reduziernippel



■ WINKELSTÜCKE

Werkstoffe

Werkstoff: Messing vernickelt

Technische Daten

Betriebsdruck: max. 20 bar
 Betriebstemperatur: max. 150°C
 Innengewinde: zylindrisch
 Außengewinde: konisch

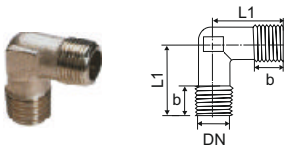

Art. Nr.	Anschluss nach ISO 7/1		DN mm	Druck bar	L1 mm	b mm	SW
	IG	AG					
LHN100.A	-	1/8"	6	150	18,5	7,5	10
LHN100.B	-	1/4"	8	100	23,5	11,0	12
LHN100.C	-	3/8"	11	75	26,5	11,5	14

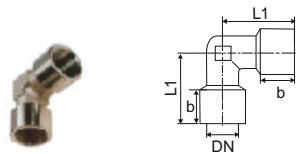

Art. Nr.	Anschluss nach ISO 7/1		DN mm	Druck bar	L1 mm	b mm	SW
	IG	AG					
LHN101.A	1/8"	-	6	150	21,0	7,5	10
LHN101.B	1/4"	-	8	100	25,0	11,0	13
LHN101.C	3/8"	-	11	75	28,0	11,5	17

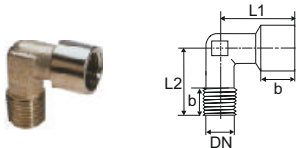

Art. Nr.	Anschluss nach ISO 7/1		DN mm	Druck bar	L1 mm	L2 mm	b mm	SW
	IG	AG						
LHN102.A	1/8"	1/8"	6	150	21,0	18,5	7,5	10
LHN102.B	1/4"	1/4"	8	100	25,0	23,5	11,0	13
LHN102.C	3/8"	3/8"	11	75	28,0	26,5	11,5	17

■ T - STÜCKE

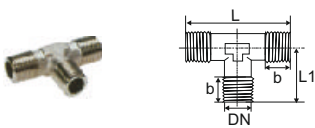

Art. Nr.	Anschluss nach ISO 7/1		DN mm	Druck bar	L mm	L1 mm	b mm	SW
	IG	AG						
LHN200.A	-	1/8"	6	150	35,0	18,0	7,5	10
LHN200.B	-	1/4"	8	100	42,0	23,0	11,0	13
LHN200.C	-	3/8"	11	75	52,0	26,0	11,5	17

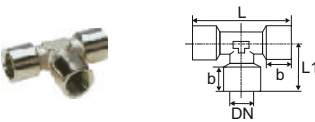

Art. Nr.	Anschluss nach ISO 7/1		DN mm	Druck bar	L mm	L1 mm	b mm	SW
	IG	AG						
LHN201.A	1/8"	-	6	150	39,0	19,0	7,5	10
LHN201.B	1/4"	-	8	100	49,0	24,5	11,0	13
LHN201.C	3/8"	-	11	75	52,0	27,0	11,5	17

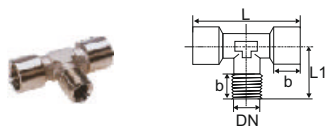

Art. Nr.	Anschluss nach ISO 7/1		DN mm	Druck bar	L mm	L1 mm	b mm	SW
	IG	AG						
LHN202.A	1/8"	1/8"	6	150	40,0	18,0	7,5	10
LHN202.B	1/4"	1/4"	8	100	49,0	23,0	11,0	13
LHN202.C	3/8"	3/8"	11	75	54,0	26,0	11,5	17

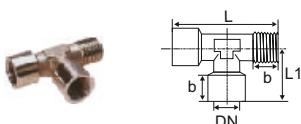

Art. Nr.	Anschluss nach ISO 7/1		DN mm	Druck bar	L mm	L1 mm	b mm	SW
	IG	AG						
LHN203.A	1/8"	1/8"	6	150	37,0	19,5	7,5	10
LHN203.B	1/4"	1/4"	8	100	47,5	24,5	11,0	13
LHN203.C	3/8"	3/8"	11	75	53,0	27,0	11,5	17

T - STÜCKE

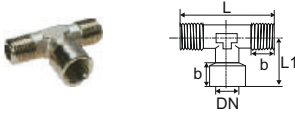

Art. Nr.	Anschluss nach ISO 7/1		DN mm	Druck bar	SW
	IG	AG			
LHN204.A	1/8"	1/8"	6	150	10
LHN204.B	1/4"	1/4"	8	100	13

KREUZ - STÜCK

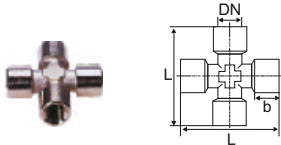

Art. Nr.	Anschluss nach ISO 7/1		DN mm	Druck bar	L mm	b mm	SW
	IG	AG					
LHN210.A	-	1/8"	6	150	40,0	7,5	10
LHN210.B	-	1/4"	8	100	50,0	11,0	13
LHN210.C	-	3/8"	11	75	56,0	11,5	17

EINSCHRAUBSCHLAUCHTÜLLE

MIT AUßENGEWINDE ZYLINDRISCH

Werkstoffe

Werkstoff: Messing blank

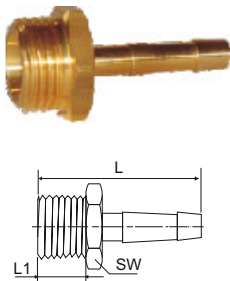

Art. Nr.	Gewinde AG	Anschluss für Schlauch Lw mm	L mm	L1 mm	SW
LHX239.A04	1/8"	4	41,5	9,0	14
LHX239.A06	1/8"	6	41,5	9,0	14
LHX239.A09	1/8"	9	48,5	10,0	17
LHX239.B04	1/4"	4	48,5	10,0	17
LHX239.B06	1/4"	6	48,5	10,0	17
LHX239.B09	1/4"	9	48,5	10,0	17
LHX239.B13	1/4"	13	48,5	10,0	19
LHX239.C04	3/8"	4	48,5	10,0	19
LHX239.C06	3/8"	6	48,5	10,0	19
LHX239.C09	3/8"	9	48,5	10,0	19
LHX239.C13	3/8"	13	48,5	10,0	19
LHX239.D06	1/2"	6	48,5	10,0	24
LHX239.D09	1/2"	9	48,5	10,0	24
LHX239.D13	1/2"	13	50,0	10,0	24
LHX239.D16	1/2"	16	58,0	10,0	20
LHX239.D19	1/2"	19	63,0	10,0	20

ANSCHRAUBSCHLAUCHTÜLLE

MIT INNENGEWINDE

Werkstoffe

Werkstoff: Messing blank

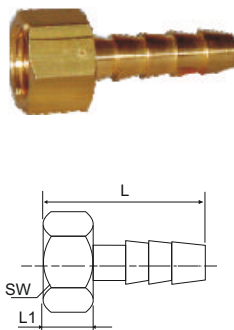

Art. Nr.	Gewinde IG	Anschluss für Schlauch Lw mm	L mm	L1 mm	SW
LHX240.Ai8	1/8"	8	35,0	10,0	12
LHX240.Bi6	1/4"	6	36,0	11,0	15
LHX240.Bi8	1/4"	8	36,0	11,0	15
LHX240.Bi10	1/4"	10	36,0	11,0	15
LHX240.Bi13	1/4"	13	40,5	11,0	17
LHX240.Ci6	3/8"	6	36,0	11,0	19
LHX240.Ci8	3/8"	8	36,0	11,0	19
LHX240.Ci10	3/8"	10	36,0	11,0	19
LHX240.Ci13	3/8"	13	40,5	11,0	19
LHX240.Di6	1/2"	6	36,0	14,5	23
LHX240.Di8	1/2"	8	36,0	14,5	23
LHX240.Di10	1/2"	10	36,0	14,5	23
LHX240.Di13	1/2"	13	44,0	14,5	23

■ EINSCHRAUBSCHLAUCHTÜLLE

MIT AUßENGEWINDE

Werkstoffe

Werkstoff: Messing vernickelt

Technische Daten

Betriebsdruck max. 60 bar
Temperaturbeständigkeit: max. 150°C

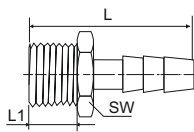

Art. Nr.	Gewinde AG	Anschluss für Schlauch		SW
		L _w mm	L mm	
LHN239.A06	1/8"	6	32,0	12
LHN239.A08	1/8"	8	32,0	12
LHN239.A09	1/8"	9	32,0	12
LHN239.A10	1/8"	10	32,0	12
LHN239.B06	1/4"	6	35,0	14
LHN239.B08	1/4"	8	35,0	14
LHN239.B09	1/4"	9	35,0	14
LHN239.B10	1/4"	10	35,0	14
LHN239.B12	1/4"	12	35,0	14
LHN239.C09	3/8"	9	36,0	17
LHN239.C10	3/8"	10	36,0	17
LHN239.C12	3/8"	12	36,0	17
LHN239.D09	1/2"	9	39,0	22
LHN239.D10	1/2"	10	39,0	22
LHN239.D12	1/2"	12	39,0	22

■ VERSCHLUSSSCHRAUBE

MIT INNENSECHKANT

Werkstoffe

Werkstoff: Messing vernickelt

Technische Daten

Betriebsdruck 60 bar

Verschlusssschraube mit Innensechkant

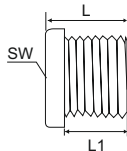

Art. Nr.	Gewinde AG	L mm	L1 mm	SW
LHN8008.B1	1/4"	15,0	12,0	6
LHN8008.C	3/8"	15,0	12,0	8
LHN8008.D1	1/2"	18,0	14,0	10

Verschlusssschraube mit Innensechkant, konisch

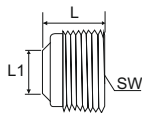

Art. Nr.	Gewinde AG	L mm	L1 mm	SW
LHN8012.B	1/4"	10,0	11,0	6
LHN8012.C	3/8"	10,0	14,0	8
LHN8012.D	1/2"	11,0	18,0	10

Verschlusssschraube mit Außengewinde, zylindrisch

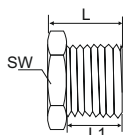

Art. Nr.	Gewinde AG	L mm	L1 mm	SW
LHN8008.A	1/8"	10,0	5,0	14
LHN8008.B	1/4"	10,0	6,0	17
LHN8008.C2	3/8"	13,0	8,0	19
LHN8008.D	1/2"	13,0	8,0	24

■ ÜBERWURFMUTTER

Werkstoffe

Werkstoff: Messing vernickelt, Messing blank

Technische Daten

Betriebsdruck 60 bar



Überwurfmutter - Messing vernickelt

Art. Nr.	Gewinde		SW
	IG		
LHN8004.A	1/8"		14
LHK8004.B	1/4"		16
LHK8004.C	3/8"		20
LHK8004.D	1/2"		24

Überwurfmutter - Messing blank

Art. Nr.	Gewinde		SW
	IG		
LHN8003.A	1/8"		15
LHN8003.B	1/4"		17
LHN8003.C	3/8"		19
LHN8003.D	1/2"		24

■ DOPPELNIPPEL

Werkstoffe

Werkstoff: Messing vernickelt

Technische Daten

Betriebsdruck 60 bar

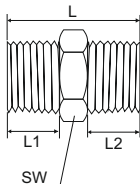

Doppelnippel, zylindrisch

Art. Nr.	Gewinde		L mm	L1 mm	L2 mm	SW
	AG	AG1				
LHN270.M55	M5	M5	11,0	4,0	4,0	8
LHN270.AM5	M5	1/8"	14,0	4,0	6,0	14
LHN270.AA1	1/8"	1/8"	16,5	6,0	6,0	14
LHN270.AB1	1/8"	1/4"	19,0	6,0	8,0	17
LHN270.AC1	1/8"	3/8"	20,0	6,0	9,0	19
LHN270.BB1	1/4"	1/4"	21,0	8,0	8,0	17
LHN270.BC1	1/4"	3/8"	22,0	8,0	9,0	19
LHN270.BD1	1/4"	1/2"	23,5	8,0	10,0	24
LHN270.CC1	3/8"	3/8"	23,0	9,0	10,0	19
LHN270.CD1	3/8"	1/2"	24,5	9,0	10,0	24

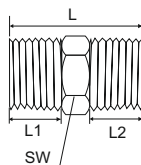

Doppelnippel, kegelig

Art. Nr.	Gewinde		L mm	L1 mm	L2 mm	SW
	AG	AG1				
LHN280.AA1	1/8"	1/8"	19,0	7,5	7,5	12
LHN280.AB1	1/8"	1/4"	22,5	7,5	10,0	14
LHN280.AC1	1/8"	3/8"	22,5	7,5	10,0	17
LHN280.BB1	1/4"	1/4"	25,0	10,0	10,0	14
LHN280.BC1	1/4"	3/8"	25,0	10,0	10,0	17
LHN280.BD1	1/4"	1/2"	28,0	10,0	12,0	22
LHN280.C	3/8"	3/8"	25,0	10,0	10,0	17
LHN280.CD1	3/8"	1/2"	28,0	10,0	12,0	22

■ DOPPELNIPPEL

Werkstoffe

Werkstoff: Messing blank

Technische Daten

Betriebsdruck 60 bar

Außengewinde zylindrisch

Art. Nr.	Gewinde		L mm	L1 mm	SW
	AG	AG1			
LHX270.M55	M5	M5	13,0	8,0	7
LHX270.AM5	M5	1/8"	17,0	12,0	14
LHX270.AA1	1/8"	1/8"	21,0	13,0	14
LHX270.AB1	1/8"	1/4"	22,0	14,0	14
LHX270.AC1	1/8"	3/8"	25,0	16,0	19
LHX270.BB1	1/4"	1/4"	23,0	14,0	17
LHX270.BC1	1/4"	3/8"	24,0	15,0	19
LHX270.BD1	1/4"	1/2"	27,0	18,0	24
LHX270.CC1	3/8"	3/8"	25,0	15,0	19
LHX270.CD1	3/8"	1/2"	27,0	17,0	24
LHX270.CE1	3/8"	3/4"	36,0	24,0	32
LHX270.DD1	1/2"	1/2"	29,0	17,0	24

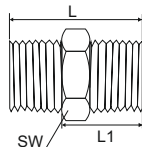

■ REDUZIERNIPPEL

AUßENGEWINDE ZYLINDRISCH

Werkstoffe

Werkstoff: Messing vernickelt

Technische Daten

Betriebsdruck 60 bar

Art. Nr.	Gewinde		L mm	L1 mm	SW
	AG	IG			
LHN250.AM5	1/8"	M5	10,0	6,0	14
LHN250.BA1	1/4"	1/8"	13,0	8,0	17
LHN250.CA1	3/8"	1/8"	14,0	9,0	19
LHN250.CB1	3/8"	1/4"	14,0	9,0	19
LHN250.DA1	1/2"	1/8"	18,0	12,0	25
LHN250.DB1	1/2"	1/4"	15,0	9,0	24
LHN250.DC1	1/2"	3/8"	15,0	9,0	24

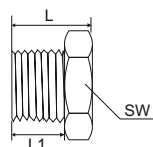

Art. Nr.	Gewinde		L mm	L1 mm	SW
	AG	IG			
LHN260.M55	M5	M5	11,0	4,0	8
LHN260.AM5	M5	1/8"	14,0	4,0	14
LHN260.AA1	1/8"	1/8"	16,0	6,0	14
LHN260.AB1	1/8"	1/4"	19,0	6,0	17
LHN260.AC1	1/8"	3/8"	20,0	6,0	22
LHN260.BB1	1/4"	1/4"	21,0	8,0	17
LHN260.BC1	1/4"	3/8"	21,0	8,0	22
LHN260.BD1	1/4"	1/2"	24,0	8,0	27
LHN260.CC1	3/8"	3/8"	23,0	9,0	22
LHN260.CD1	3/8"	1/2"	25,0	9,0	27

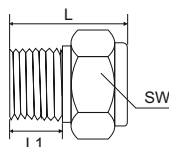

■ REDUZIERNIPPEL

Werkstoffe

Werkstoff: Messing blank

Technische Daten

Betriebsdruck 60 bar

Art. Nr.	Gewinde		L mm	L1 mm	SW
	AG	IG			
LHX250.AM5	1/8"	M5	11,0	7,0	14
LHX250.BM5	1/4"	M5	14,0	10,0	17
LHX250.BA1	1/4"	1/8"	13,0	8,0	17
LHX250.CA1	3/8"	1/8"	13,0	9,5	19
LHX250.CB1	3/8"	1/4"	13,0	9,5	19
LHX250.DA1	1/2"	1/8"	18,0	12,0	24
LHX250.DB1	1/2"	1/4"	15,5	11,5	22
LHX250.DC1	1/2"	3/8"	15,5	11,5	22

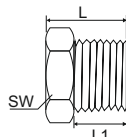

■ REDUZIERNIPPEL

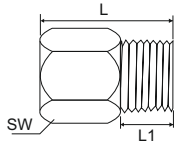

Art. Nr.	Gewinde		L mm	L1 mm	SW
	AG	IG			
LHX260.AM5	1/8"	M5	17,0	7,0	14
LHX260.AA5	1/8"	1/8"	23,0	8,0	14
LHX260.AB1	1/8"	1/4"	26,0	10,0	17
LHX260.BA1	1/4"	1/8"	28,0	10,0	17
LHX260.BB1	1/4"	1/4"	28,0	10,0	17
LHX260.BC1	1/4"	3/8"	26,0	10,0	19
LHX260.CB1	3/8"	1/4"	29,0	10,0	19
LHX260.CC1	3/8"	3/8"	29,0	10,0	19
LHX260.CD1	3/8"	1/2"	27,0	12,0	24

■ REDUZIERNIPPEL

Werkstoffe

Werkstoff:

Messing vernickelt

Technische Daten

Betriebsdruck

60 bar

Gerader Einschraubverbinder, konisch

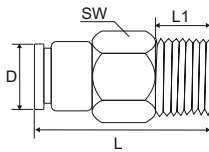

Art. Nr.	Gewinde AG	Außen- Ø Rohr	L mm	L1 mm	D mm	SW
LHN2000.A06	1/8"	6	20,5	7,5	12,0	12
LHN2000.A08	1/8"	8	24,5	7,5	14,0	14
LHN2000.B04	1/4"	4	20,0	11,0	9,0	14
LHN2000.B06	1/4"	6	20,0	11,0	12,0	14
LHN2000.B08	1/4"	8	23,0	11,0	14,0	14
LHN2000.B10	1/4"	10	30,0	11,0	16,0	16
LHN2000.C08	3/8"	8	22,0	11,5	14,0	17
LHN2000.C10	3/8"	10	23,5	11,5	16,0	17
LHN2000.C12	3/8"	12	27,0	11,5	18,0	18
LHN2000.C14	3/8"	14	35,0	11,5	22,0	22

Gerader Einschraubverbinder, zylindrisch

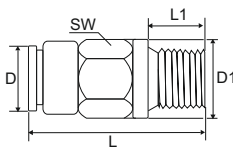

Art. Nr.	Gewinde AG	Außen- Ø Rohr	L mm	L1 mm	D mm	D1 mm	SW
LHN2000.M54	M5	4	18,5	4,0	9,0	9,0	-
LHN2000.M56	M5	6	21,5	4,0	12,0	8,0	-
LHN2005.A04	1/8"	4	16,0	5,0	9,0	13,0	9
LHN2005.A06	1/8"	6	19,0	5,0	12,0	13,5	12
LHN2005.A08	1/8"	8	22,5	5,0	14,0	13,0	13
LHN2005.B04	1/4"	4	18,0	6,5	9,0	16,0	9
LHN2005.B06	1/4"	6	18,5	6,5	12,0	16,0	12
LHN2005.B08	1/4"	8	21,0	6,5	14,0	16,0	14
LHN2005.C08	3/8"	8	20,5	7,0	14,0	20,0	14
LHN2005.C10	3/8"	10	24,5	7,0	16,0	20,0	16

Gerader Aufschraubverbinder

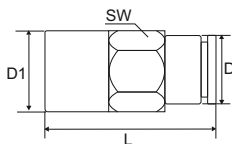

Art. Nr.	Gewinde IG	Außen- Ø Rohr	L mm	L1 mm	D mm	SW
LHN2001.A06	1/8"	6	25,5	7,5	12,0	12
LHN2001.A08	1/8"	8	26,0	7,5	14,0	14
LHN2001.B06	1/4"	6	29,5	11,0	12,0	12
LHN2001.B08	1/4"	8	29,5	11,0	14,0	14
LHN2001.B10	1/4"	10	31,5	11,0	16,0	16
LHN2001.C10	3/8"	10	33,0	12,0	16,0	16

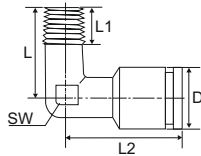

Winkel- Einschraubverbinder, konisch

Art. Nr.	Gewinde AG	Außen- Ø Rohr	L mm	L1 mm	L2 mm	D mm	SW
LHN2050.A04	1/8"	4	15,0	7,5	17,0	9,0	9
LHN2050.A06	1/8"	6	15,0	7,5	20,0	12,0	10
LHN2050.A08	1/8"	8	19,0	7,5	20,5	14,0	12
LHN2050.B06	1/4"	6	18,5	11,0	20,0	12,0	10
LHN2050.B08	1/4"	8	21,0	11,0	20,5	14,0	12
LHN2050.B10	1/4"	10	22,0	11,0	24,0	16,0	14
LHN2050.C10	3/8"	10	22,5	11,5	24,0	16,0	14

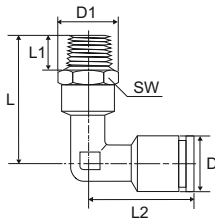

Schwenk- Winkel- Einschraubverbinder, konisch

Art. Nr.	Gewinde AG	Außen- Ø Rohr	L mm	L1 mm	L2 mm	D mm	D1 mm	SW
LHN2051.A04	1/8"	4	19,5	7,5	19,0	9,0	14,5	13
LHN2051.A06	1/8"	6	19,5	7,5	21,5	12,0	14,5	13
LHN2051.A08	1/8"	8	19,5	7,5	22,0	14,0	14,5	13
LHN2051.B04	1/4"	4	23,0	11,0	19,0	9,0	15,5	14
LHN2051.B06	1/4"	6	23,0	11,0	21,5	12,0	15,5	14
LHN2051.B08	1/4"	8	23,0	11,0	22,0	14,0	15,5	14
LHN2051.B10	1/4"	10	25,5	11,0	25,0	16,0	20,0	18
LHN2051.C08	3/8"	8	26,0	11,5	23,0	14,0	20,0	18
LHN2051.C10	3/8"	10	26,0	11,5	25,0	16,0	20,0	18
LHN2051.C12	3/8"	12	29,5	11,5	28,0	18,0	22,5	20

Schwenk- Winkel- Aufschraubverbinder

Art. Nr.	Gewinde AG	Außen- Ø Rohr	L mm	L1 mm	L2 mm	D mm	D1 mm	SW
LHN2054.A04	1/8"	4	17,5	7,5	19,0	9,0	14,5	13
LHN2054.A06	1/8"	6	17,5	7,5	21,5	12,0	14,5	13
LHN2054.A08	1/8"	8	17,5	7,5	22,0	14,0	14,5	13
LHN2054.B06	1/4"	6	21,5	11,0	21,5	12,0	18,0	14
LHN2054.B08	1/4"	8	21,5	11,0	22,0	14,0	18,0	14
LHN2054.B10	1/4"	10	23,0	11,0	25,0	16,0	18,0	14
LHN2054.C10	3/8"	10	25,0	12,0	25,0	16,0	22,5	18

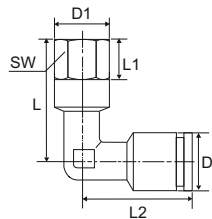

L- Einschraubverbinder, drehbar, konisch

Art. Nr.	Gewinde	Außen- Ø Rohr	L mm	L1 mm	L2 mm	L3 mm	D mm	D1 mm	SW
LHN2004.A04	AG1/8	4	38,5	7,5	19,5	19,0	9,0	14,5	13
LHN2004.A06	AG1/8	6	41,0	7,5	19,5	21,5	12,0	14,5	13
LHN2004.A08	AG1/8	8	41,5	7,5	19,5	22,0	14,0	14,5	13
LHN2004.B04	AG1/4	4	42,0	11,0	23,0	19,0	9,0	15,5	14
LHN2004.B06	AG1/4	6	44,5	11,0	23,0	21,5	12,0	15,5	14
LHN2004.B08	AG1/4	8	45,0	11,0	23,0	22,0	14,0	15,5	14
LHN2004.B10	AG1/4	10	50,5	11,0	25,5	25,0	16,0	20,0	18
LHN2004.C10	AG3/8	10	51,0	11,5	26,0	25,0	16,0	20,0	18
LHN2004.C12	AG3/8	12	57,5	11,5	29,5	28,0	18,0	20,5	20

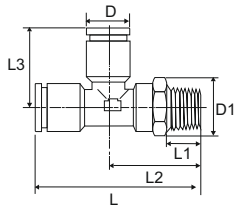

T- Verbinder

Art. Nr.	Außen- Ø Rohr	L mm	L1 mm	D mm
LHN2030.004	4	33,0	16,5	9,0
LHN2004.006	6	39,0	19,5	12,0
LHN2004.008	8	41,0	20,5	14,0
LHN2004.010	10	48,0	24,0	16,0
LHN2004.012	12	52,0	26,0	18,0
LHN2004.014	14	60,0	30,0	22,0

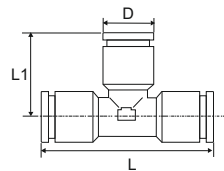

■ MUFFE

Werkstoffe

Werkstoff: Messing vernickelt

Technische Daten

Betriebsdruck 60 bar

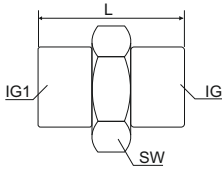

Art. Nr.	Gewinde		L mm	SW
	IG	IG1		
LHN8006.M55	M5	M5	11,0	8
LHN8006.AM5	M5	1/8"	13,0	14
LHN8006.A	1/8"	1/8"	15,0	14
LHN8006.AB	1/8"	1/4"	19,0	17
LHN8006.AC	1/8"	3/8"	20,0	22
LHN8006.BB	1/4"	1/4"	22,0	17
LHN8006.BC	1/4"	3/8"	23,0	22
LHN8006.BD	1/4"	1/2"	26,0	17
LHN8006.C	3/8"	3/8"	24,0	22
LHN8006.CD	3/8"	1/2"	26,0	27

■ VERLÄNGERUNGSTÜCK

Werkstoffe

Werkstoff: Messing vernickelt

Technische Daten

Betriebsdruck 60 bar

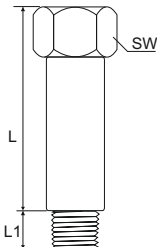

Art. Nr.	Gewinde	AG	L		SW
			mm	mm	
LHN265.AA1	1/8"		6,0	22	12
LHN265.AA2	1/8"		6,0	44	12
LHN265.BB1	1/4"		8,0	28	16
LHN265.BB2	1/4"		8,0	45	16

■ KONTAKT

Wenn Sie Fragen haben oder weitere Informationen benötigen, dann kontaktieren Sie uns bitte:

Metzger Technik GmbH
Bertha-Benz-Straße 1
D - 71665 Vaihingen a. d. Enz

Tel. +49 (0) 7042 / 81518 - 0

Mail: info@metzger-technik.de

